

- For additional protection, the installation of a residual current device(RCD) having a rated residual operating current not exceeding 30mA is advisable in the electric circuit supplying the bathroom. Ask your installer for details and advice.
- In order to avoid a hazard, manufacturer, service agent or similarly qualified person is a person responsible for their safety.
 - If the cord is damaged, it must be replaced by the manufacturer, service agent or similarly qualified person.
 - If the machine doesn't work or is behaving abnormally, (including children) with reduced physical, sensory or mental capabilities, or lack of experience and knowledge, unless they are supervised and/or have been instructed on the proper use of the machine from a person responsible for their safety.
 - This appliance is not intended for use by persons power source.
 - Do not install when the machine is connected to a power source.
 - Machine must have reliable ground connection.
 - Supplier to check and repair.
 - If power tolerance is over +/- 10%, there will be breakdown. Incorrect power supply usage will lead to fire, electric shock, and/or machine malfunction.
 - If power tolerance is over +/- 10%, there will be breakdown. Incorrect power supply usage will lead to fire, electric shock, and/or machine malfunction.
 - If using with other appliances, the socket may produce abnormal heat leading to fire.
 - The risk of electric shock.
 - Air filter must be installed.
 - Power must be cut off during maintenance to eliminate the risk of electric shock.
 - Do not modify or disassemble the unit unnecessarily. This may cause electric shock, fire, or personal injury malfunction.
 - Do not use in a wet environment, where it may come into direct contact with water or where condensation may form. This may cause electric shocks or unit malfunction.
 - Do not let the unit get wet. It can cause electric shocks the unit to fall.
 - Do not let children hang from the unit, this may cause electrocution.
 - Do not open the front panel. There is the risk of

If you don't use this unit properly or follow the safety guidelines carefully, it can lead to serious personal injury and property damage

WARNING

Heating power	650-750W	N.W.	4.1kg
Wind speed	252 kph	Appearance size	312X302X172mm
Input	1450W	Protection class	IPX1
Phase	Single-phase	Sensing distance	15-20cm
Voltage	AC120V	Motor	Brush motor

SPECIFICATIONS

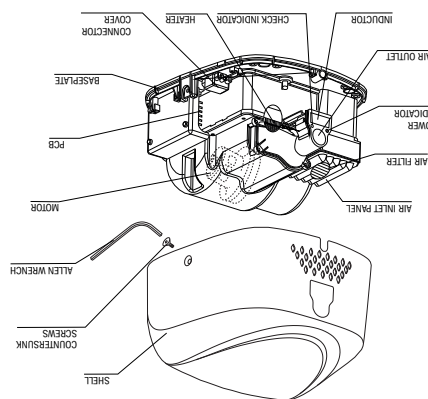

PART NAMES

- Automatic heating system
- 45 seconds
- Auto-stop function: the built in timer will stop the unit after
- Elegant stainless steel shell
- Easy to maintain
- Eliminates need for paper towels
- No touch hand drying increases hygiene

FEATURES

- Environmental Protection
- Electrical waste products should not be disposed of or household waste. Please recycle where facilities exist. Check with your local Authority or retailer for recycling advice.



DAILY USE AND MAINTENANCE

External Maintenance

- Wipe with a soft dry cloth.
- Use a soft cloth dampened with neutral detergent if the unit becomes excessively dirty. Then wipe with a dry cloth.
- Do not use organic solvents, acid or alkali toilet cleaner, cleaning brushes, etc.
- Otherwise the surface finish may become damaged and discoloration may occur.



Cleaning the Air Filter

- Clean filter semi-annually or when the air speed decreases.
- Open the air inlet panel, pull the air filter out by the handle.
 - Tap the filter lightly or use a vacuum cleaner to suck away dust. A brush can also be used, or the filter can be cleaned directly with water. Reuse after dried.
 - Reattach to the unit once clean

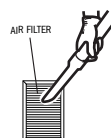

Daily use

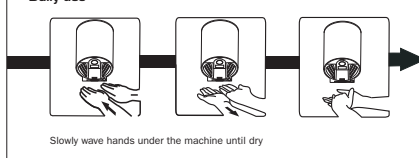

PACKING LIST

INCLUDES: MAIN MACHINE (1)
5x25mm SELF TAPPING SCREW (4)
5mm EXPANSION PIPE (4)
USER MANUAL (1)
ALLEN WRENCH (1)

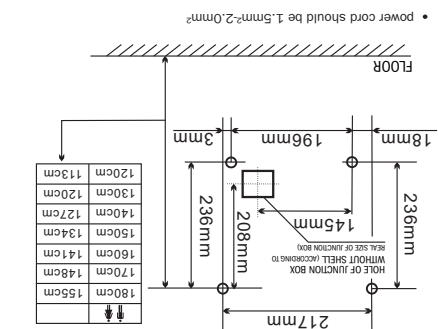

- The following picture shows the recommended installation location:
- That is over 200mm above sea level
- That is filled with corrosive, oxidizing or reducing gas
- In direct sunlight, or strong light
- That is directly sprinkled with water or where condensation forms easily
- Where the temperature is less than -10°C or over 40°C
- Do not install in the following places:
- The machine doesn't work or is behaving abnormally, (including children) with reduced physical, sensory or mental capabilities, or lack of experience and knowledge, unless they are supervised and/or have been instructed on the proper use of the machine from a person responsible for their safety.
- If the cord is damaged, it must be replaced by the manufacturer, service agent or similarly qualified person.
- In order to avoid a hazard, manufacturer, service agent or similarly qualified person is a person responsible for their safety.
- For additional protection, the installation of a residual current device(RCD) having a rated residual operating current not exceeding 30mA is advisable in the electric circuit supplying the bathroom. Ask your installer for details and advice.

PRECAUTIONS BEFORE INSTALLATION AND INSTALLATION LOCATION

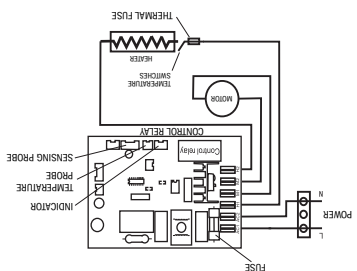

ELECTRICAL DIAGRAM

INSTALLATION METHOD

1 Connect the Line

- When installing the dryer without a junction box, install a two-hole standard outlet above the right side of the hand dryer that corresponds to the dryer. The distance should be 20-50cm.
- Embed the junction box without a cover when you are connecting directly to the power cord.

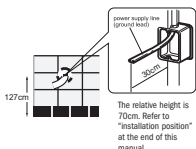

2 Remove the Shell

- Use an Allen wrench to remove two countersunk screws from the the shell
- Carefully lift up the shell to avoid scratching the cover

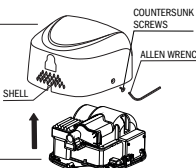

3 Install the Machine

- The unit contains a power cord. If you are using a junction box to install then you must remove the cord. Use a screw driver to draw out the wire through the thread hole to the terminal blocks and connect them.
- When connecting, the wire length should exceed 2cm to the terminal block. The Fire line must be connected at the L position, null line at the N position and earth line connected at the 0 position.

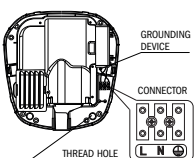

4 Reattach the Shell

- Tighten the 2 countersunk screws on the shell.

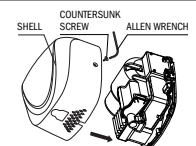

TEST RUN

STEPS	CONFIRM THAT:	BE AWARE
1 Shake the machine gently	The machine is secure and does not shake	The machine will shake noisily when not firmly installed
2 Check the power and voltage	The rated voltage is being used	Accidents can occur and the machine will burn out if incorrect power is used
3 Switch on the power	Close external power supply switch or insert the power plugs	The power socket must match the machine plug. Check the power when the indicator light is dim
4 Insert hands to activate dryer	Air blows from the dryer at a high speed	Make sure hands are close to the sensor if the dryer doesn't activate

PEARL
PROFESSIONAL

HYPERSONIC
AUTOMATIC HAND DRYER

GCA292ULTRA
USER MANUAL

LIFEWITHPEARL.COM