

## General installation of the washbasin on the wall

*The washbasins can be installed in two ways: on the wall or on a furniture base. The installation process for a “wall washbasin” is described below.*

### 0. Check.

Before installing the washbasin, check that the pack includes: drain valve (or grid if applicable) and installation supports (in the case of a washbasin with sink base).

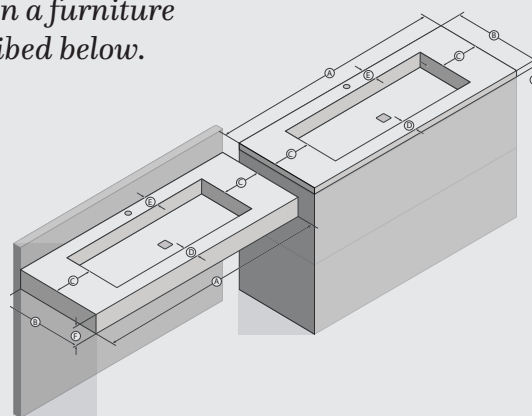

Washbasin with sink base (wall)

(on furniture base)

### To wall

#### 1. Installing the washbasin on site.

Analyse the dimensions of the washbasin and mark these on the wall. The overall height of the washbasin once installed usually ranges between 85-90 cm.

#### 2. Placement of supports.

Placement of the first support should be done by referring to the upper right corner of the flange with 4 holes. This should be placed vertically, 2 cm below the chosen height and horizontally, 4-5 cm from the outside wall of the washbasin. The two supports must be perfectly levelled.

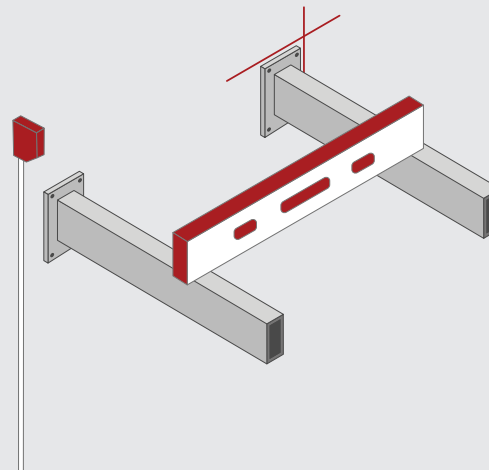

#### 3. Placement of the washbasin on the supports.

3.1. One lateral support must be placed at each end, with a maximum distance of 120 cm between each support. The maximum weight that each support can bear is over 150 kg, as indicated in the regulations that apply.

3.2. If it has a twin washbasin, it will be necessary to place a third intermediate support at an equidistant position. So that the weight is distributed.

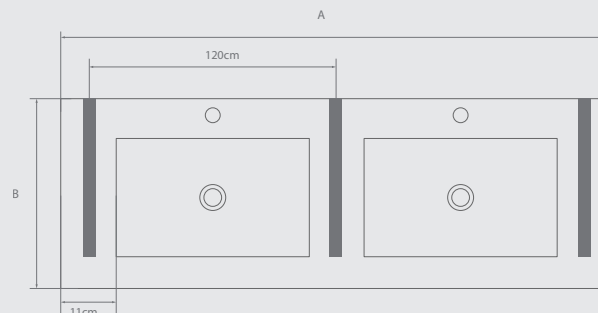

#### ***4. Application of the adhesive and final washbasin installation.***

4.1. Before positioning the washbasin, apply silicone on the upper edge of the support and on the internal perimeter edge of the washbasin countertop. A minimum joint of 3 mm between the washbasin and the wall should be left.

4.2. Immediately afterwards, place the worktop on the supports, checking that the sink is centred and level.

4.3. Clean the positioning area.

4.4. Seal with silicone in the area between the washbasin and the wall.

4.5. Next, install the tap fittings and drain connections.

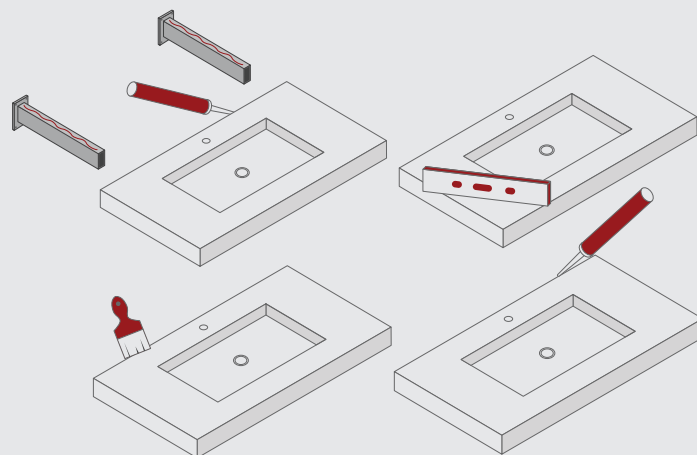

#### ***5. Completion of other works (optional)***

If the model includes a vertical leg, to complete the installation, silicone should be applied over the entire upper edge of the leg and then glued to the sink.

The leg is not to support the weight of the washbasin, it is an aesthetic element

